

**SANITARIO**

**MATERIA PRIMA**

**ACCESORIO DECORACIÓN**

**ROSCADO, BRIDAS, SOLDAR**

**BOMBAS E INTERCAMBIADORES**

**CONEXIONES RÁPIDAS Y MANGUERAS**



**t a s a e**  
aceros  
especiales s.l.

Accesorio Roscado



Válvulas



Bridas



Soldar







Válvula de Bola 2 Piezas Rosca Hembra

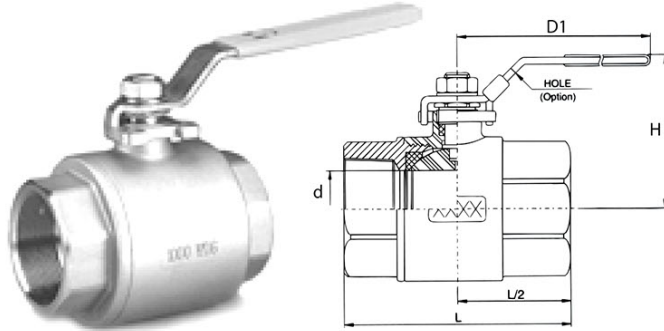

SIZE	d	L	D1	H	ΦPad	h	Cv
1/4	8	0.43 11.0	2.34 59.5	3.94 100	2.11 53.5	1.42 36	M5xPO.8 6
3/8	10	0.40 12.5	2.34 59.5	3.94 100	2.22 56.4	1.42 36	M5xPO.8 12
1/2	15	0.59 15.0	2.52 64.0	4.02 102	2.17 55.0	1.42 36	M5xPO.8 19
3/4	20	0.79 20.0	3.03 77.0	4.96 126	2.60 66.0	1.42 36	M5xPO.8 37
1	25	0.98 25.0	3.57 90.8	4.96 126	2.80 71.0	1.42 36	M5xPO.8 64
1 1/4	32	1.26 32.0	3.87 98.3	5.98 152	3.50 89.0	1.97 50	M6xP1.0 103
1 1/2	40	1.50 38.0	4.63 117.5	5.98 152	3.62 92.0	1.97 50	M6xP1.0 143
2	50	2.00 50.8	5.35 136.0	7.48 190	4.21 107.0	1.97 50	M6xP1.0 360
2 1/2	65	2.56 65.0	6.50 165.0	7.48 190	4.69 119.0	2.76 70	M8xP1.25 440
3	80	3.15 80.0	7.62 193.5	11.81 300	5.16 131.0	4.02 102	M10xP1.5 520
4	100	3.94 100.0	8.50 216.0	14.96 380	6.73 171.0	4.02 102	M10xP1.5 650

Válvula de Bola 3 Piezas Roscada Hembra

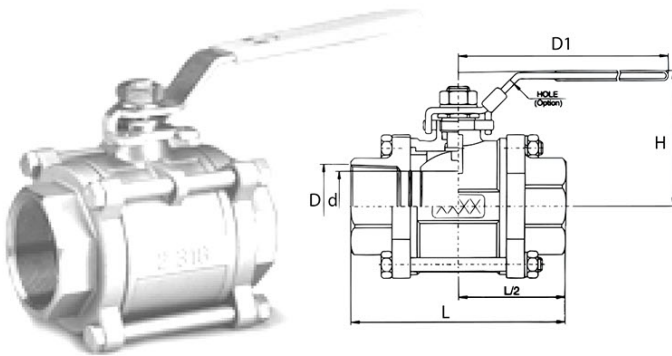

SIZE	d	L	D1	H	W2	h	Cv
1/4	8	0.43 11.0	2.56 65	4.02 102	4.02 53.5	1.42 36	M5xPO.8 6
3/8	10	0.40 12.5	2.56 65	4.02 102	4.02 56.4	1.42 36	M5xPO.8 12
1/2	15	0.59 15.0	2.80 71	4.02 102	4.02 55.0	1.42 36	M5xPO.8 19
3/4	20	0.79 20.0	3.35 85	4.96 126	4.96 66.0	1.42 36	M5xPO.8 37
1	25	0.98 25.0	3.74 95	4.96 126	4.96 71.0	1.42 36	M5xPO.8 64
1 1/4	32	1.26 32.0	4.37 111	5.91 150	5.91 89.0	1.97 50	M6xP1.0 103
1 1/2	40	1.50 38.0	4.76 121	5.91 150	5.91 92.0	1.97 50	M6xP1.0 143
2	50	2.00 50.8	5.51 140	7.32 186	7.32 107.0	1.97 50	M6xP1.0 360
2 1/2	65	2.56 65.0	6.81 173	10.71 272	10.71 119.0	2.76 70	M8xP1.25 440
3	80	3.15 80.0	7.56 192	10.71 272	10.71 131.0	4.02 102	M10xP1.5 520
4	100	3.94 100.0	8.86 225	13.19 335	13.19 171.0	4.02 102	M10xP1.5 820

Válvula de Bola 3 Piezas Roscada Hembra ISO Pad

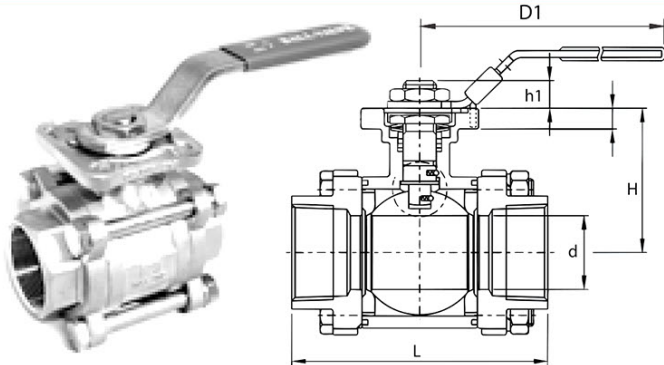

SIZE	d	L	D1	ISO 5211	A	B	h1	h2	d3	R1	R2	Torque	
1	25	25,4	95	127	F04/F05	45	10	12	60	50	4,5	5,5	11
1 1/4	32	32	111	127	F04/F05	55	10	12	63	50	4,5	5,5	15
1 1/2	40	40	121	149	F05/F07	60	10	16	79	70	4,5	5,5	20
2	50	50,8	140	149	F05/F07	75	10	16	87	70	4,5	5,5	40
2 1/2	65	65	185	325	F07/F10	100	10	17	105	70	4,5	5,5	89
3	80	76	205	325	F07/F10	100	10	17	111	70	4,5	5,5	97
4	100	100	240	325	F10/F12	125	12	22	136	102	5,5	6,5	116

Válvula de Bola 3 Piezas Soldar

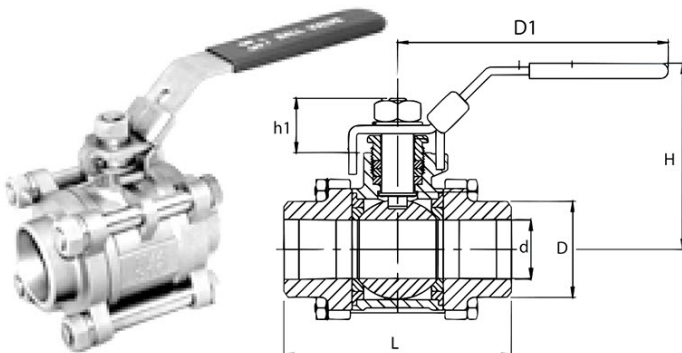

SIZE	d	L	H	D1	T	N	h1	K	D	
1	25	25	95	76	158	35	8	15,5	7/16	34
1 1/4	32	32	111,2	81	158	45	8	15,5	7/16	42,5
1 1/2	40	38	130,6	98	188	55	9	17,5	1/2	48,5
2	50	50	151	106	188	66	9	17,5	1/2	61
2 1/2	65	65	185	138	245	86	12	33	3/4	77
3	80	80	212	154	290	100	12	33	3/4	90
4	100	100	235	178	320	125	16	42	1	115



Filtro Y

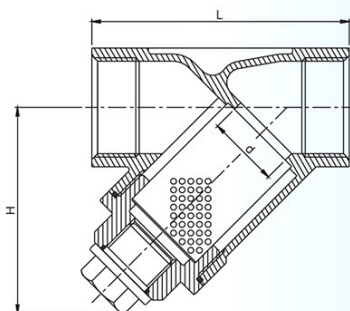

SIZE d		L	H			
inch	mm	mm	mm			
1/2	15	65	46,5			
3/4	20	80	68,5			
1	25	90	71			
1 1/4	32	105	74			
1 1/2	40	120	82,5			
2	50	140	95			
2 1/2	65	180	121			
3	80	200	138,3			

Válvula de Retención en Y

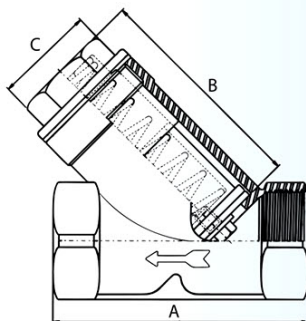

SIZE		A		B		C		
inch	mm	inch	mm	inch	mm	inch	mm	
1/4	8	2.56	65	1.81	46	0.54	19	
3/8	10	2.56	65	1.81	46	0.73	19	
1/2	15	2.56	65	1.81	46	0.22	19	
3/4	20	3.15	80	2.28	58	0.32	23	
1	25	3.54	90	2.72	69	1.06	27	
1 1/4	32	4.13	105	2.95	75	1.26	32	
1 1/2	40	4.72	120	3.35	85	1.61	41	
2	50	5.51	140	3.86	98	1.97	50	

Válvula de Retención Clapeta

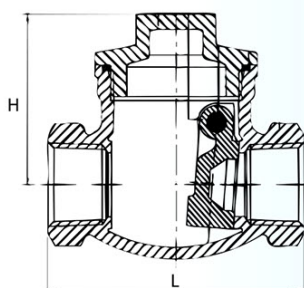

DN	Size	L	H	
inch	mm	mm	mm	
1/2	15	65	44	
3/4	20	80	52	
1	25	89	62	
1 1/4	32	105	67	
1 1/2	40	120	79	
2	50	139	80	
2 1/2	65	181	96	
3	80	200	104	

Válvula de Retención de Disco

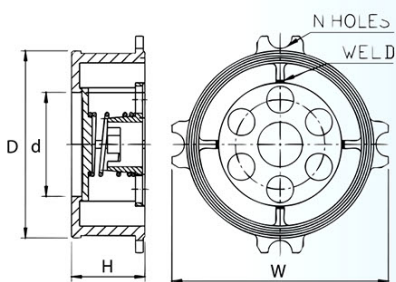

DN	d	D	H	W	N	
inch	mm	mm	mm	mm		
1/2	15	36	16	54	4	
3/4	20	43	18,5	64	4	
1	25	51	22	74	4	
1 1/4	32	63,5	27	85,5	4	
1 1/2	40	73	32	96	4	
2	50	93,5	40	111,5	4	
2 1/2	65	117	46	135,5	4	
3	80	141	50	150	6	
4	100	163	61	177	8	

TE FIG.130

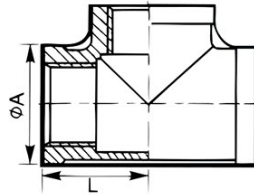

SIZE	ØA	L
1/4"	21.3	21.0
3/8"	23.5	23.6
1/2"	29.0	27.0
3/4"	35.0	33.0
1"	43.0	38.0
1-1/4"	52.0	45.0
1-1/2"	58.0	50.0
2"	71.0	58.0
2-1/2"	86.6	68.7
3"	99.2	77.8
4"	125.0	97.0

Codo 90° FIG.90

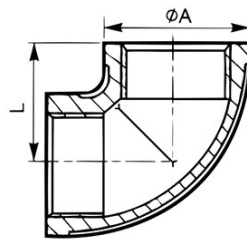

SIZE	ØA	L
1/4"	21.3	20.0
3/8"	23.5	21.3
1/2"	31.0	28.5
3/4"	37.0	33.5
1"	43.8	38.0
1-1/4"	54.5	45.0
1-1/2"	62.0	49.0
2"	75.0	56.5
2-1/2"	86.5	69.3
3"	99.0	77.5
4"	125.0	97.3

Codo 90° Estrecho FIG.92

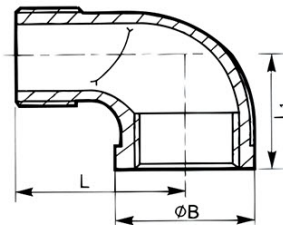

SIZE	ØB	L	L1
1/4"	18.0	28.3	19.0
3/8"	23.0	35.0	22.5
1/2"	29.0	42.0	29.5
3/4"	35.0	50.5	33.0
1"	43.0	52.0	38.0
1-1/4"	52.0	60.0	45.0
1-1/2"	58.0	65.0	50.0
2"	71.0	74.0	58.0
2-1/2"	84.0	99.5	68.0
3"	96.0	115.5	78.0
4"	121.0	146.5	97.0

Racord GAS Junta Cónica FIG.340



**K-6**

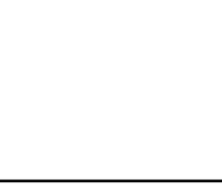
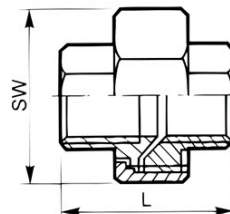

**K-6A**

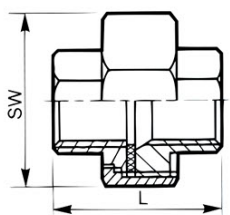

SIZE	L	SW
1/4"	37.5	30.0
3/8"	38.0	35.0
1/2"	42.0	42.0
3/4"	50.4	47.0
1"	48.0	53.0
1-1/4"	59.0	71.0
1-1/2"	64.0	78.0
2"	69.0	92.0
2-1/2"	80.0	112.0
3"	88.0	126.0
4"	108.0	157.0

SIZE	L	SW
1/4"	38.0	30.0
3/8"	38.0	35.0
1/2"	41.0	42.0
3/4"	50.4	47.0
1"	48.0	53.0
1-1/4"	59.0	71.0
1-1/2"	64.0	78.0
2"	69.0	92.0
2-1/2"	80.0	112.0
3"	88.0	126.0
4"	108.0	157.0

### Racord Soldar Junta Plana FIG.330



**K-6D**

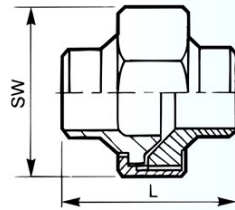

**K-6E**

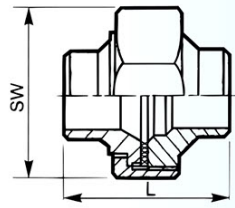

SIZE	L	SW
1/4"	35.5	30.0
3/8"	38.0	35.0
1/2"	42.0	42.0
3/4"	50.4	47.0
1"	48.0	53.0
1-1/4"	59.0	71.0
1-1/2"	64.0	78.0
2"	68.0	92.0
2-1/2"	80.0	112.0
3"	88.0	126.0
4"	108.0	157.0

SIZE	L	SW
1/4"	35.5	30.0
3/8"	38.0	35.0
1/2"	41.0	42.0
3/4"	50.4	47.0
1"	48.0	53.0
1-1/4"	59.0	71.0
1-1/2"	64.0	78.0
2"	68.0	92.0
2-1/2"	80.0	112.0
3"	88.0	126.0
4"	108.0	157.0

### Entronque FIG.149

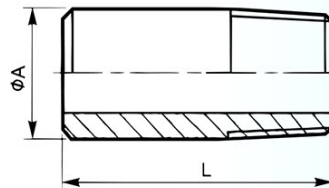

SIZE	ØA	L
1/4"	13.5	30.0
3/8"	17.2	30.0
1/2"	21.3	35.0
3/4"	26.9	40.0
1"	33.7	40.0
1-1/4"	42.4	50.0
1-1/2"	48.3	50.0
2"	60.3	50.0
2-1/2"	76.1	60.0
3"	88.9	70.0
4"	114.3	80.0

### Entronque Doble FIG.280



**DIN/BSP**

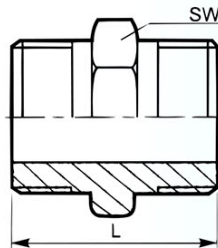

**NPT/PT**

SIZE	L	SW
1/4"	27.8	16.0
3/8"	28.0	19.0
1/2"	34.0	21.6
3/4"	40.0	30.0
1"	46.0	36.0
1-1/4"	52.5	46.0
1-1/2"	54.0	50.0
2"	62.0	65.5
2-1/2"	70.0	79.5
3"	78.4	90.0
4"	94.0	120.0

SIZE	L	SW
1/4"	32.5	17.0
3/8"	36.0	20.0
1/2"	42.5	26.0
3/4"	46.0	32.0
1"	51.5	38.0
1-1/4"	56.0	46.0
1-1/2"	59.0	52.5
2"	65.0	62.0
2-1/2"	80.0	77.0
3"	90.0	92.0
4"	107.0	118.0



### Entronque Doble FIG.150

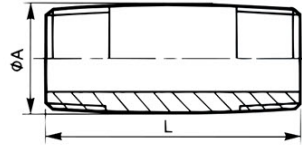

SIZE	$\varnothing A$	L		
1/4"	13.5	40.0		
3/8"	17.2	40.0		
1/2"	21.3	60.0		
3/4"	26.9	60.0		
1"	33.7	60.0		
1-1/4"	42.4	80.0		
1-1/2"	48.3	80.0		
2"	60.3	100.0		
2-1/2"	76.1	120.0		
3"	88.9	120.0		
4"	114.3	150.0		

### Tapón Hembra FIG.300

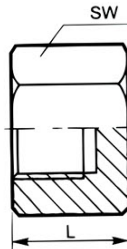

SIZE	L	SW		
1/4"	17.0	18.0		
3/8"	19.0	21.0		
1/2"	20.0	27.0		
3/4"	24.0	30.0		
1"	25.0	38.0		
1-1/4"	28.0	50.0		
1-1/2"	28.0	55.0		
2"	34.0	70.0		
2-1/2"	40.0	92.0		
3"	45.0	109.0		
4"	50.0	132.0		

### Tapón Macho FIG.290

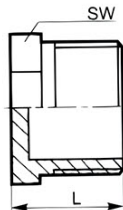

SIZE	L	SW		
1/4"	17.5	16.0		
3/8"	18.0	20.0		
1/2"	25.0	24.0		
3/4"	26.0	30.0		
1"	29.0	38.0		
1-1/4"	35.0	46.0		
1-1/2"	38.0	52.0		
2"	39.0	65.0		
2-1/2"	44.0	81.0		
3"	54.0	94.0		
4"	55.0	119.0		

### Machón Reducido FIG.245

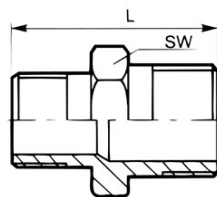

SIZE	L	SW		
3/8"x1/4"	34.0	21.0		
1/2"x3/8"	41.0	26.0		
3/4"x1/2"	45.0	30.0		
1"x1/2"	43.2	35.0		
1"x3/4"	50.0	37.0		
1-1/4"x1"	54.0	46.0		
1-1/4"x3/4"	52.0	46.0		
1-1/2"x1"	53.0	50.0		
1-1/2"x1-1/4"	59.0	50.0		
2"x1"	57.0	63.0		
2"x1-1/4"	58.0	63.0		
2"x1-1/2"	64.0	64.0		
2-1/2"x1-1/2"	66.0	80.0		
2-1/2"x2"	77.0	76.3		
3"x2"	74.0	95.0		
4"x3"	94.0	117.4		

### Tuerca Reducción Macho/Hembra FIG.241

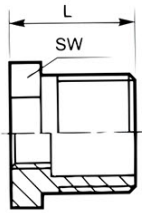

SIZE	L	SW
3/8"x1/4"	16.5	18.0
1/2"x3/8"	21.0	26.0
3/4"x1/2"	24.0	30.0
1"x1/2"	27.0	35.0
1"x3/4"	27.0	35.0
1-1/4"x1"	30.0	45.0
1-1/4"x3/4"	30.0	45.0
1-1/2"x1"	36.0	52.0
1-1/2"x1-1/4"	36.0	52.0
2"x1"	36.0	63.0
2"x1-1/4"	36.0	63.0
2"x1-1/2"	36.0	63.0
2-1/2"x1-1/2"	45.0	81.0
2-1/2"x2"	45.0	81.3
3"x2"	47.0	95.0
4"x3"	52.0	119.0

### Manguito Reducción Hembra/Hembra FIG.240

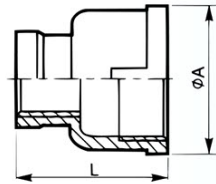

SIZE	L	SW
3/8"x1/4"	26.0	29.0
1/2"x3/8"	29.0	34.0
3/4"x1/2"	36.7	37.0
1"x1/2"	44.7	42.8
1"x3/4"	43.0	42.0
1-1/4"x1"	52.5	52.0
1-1/4"x3/4"	54.5	48.0
1-1/2"x1"	59.0	53.0
1-1/2"x1-1/4"	59.4	53.0
2"x1"	72.8	56.0
2"x1-1/4"	72.0	56.0
2"x1-1/2"	72.0	57.0
2-1/2"x1-1/2"	86.7	60.0
2-1/2"x2"	86.8	60.8
3"x2"	98.0	62.0
4"x3"	128.0	65.0

### Entronque Manguera FIG.399

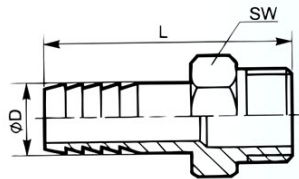

SIZE	L	SW	Ø D	
1/4"	47.0	16.5	9.0	6.3
3/8"	55.0	20.0	11.0	9.5
1/2"	64.0	23.5	14.0	12.7
3/4"	68.0	31.0	20.5	19.0
1"	71.0	38.5	27.0	25.4
1-1/4"	80.0	46.0	33.0	31.8
1-1/2"	95.0	52.0	39.5	38.1
2"	105.0	62.0	52.0	50.8
2-1/2"	107.0	80.0	67.0	63.5
3"	112.0	91.0	80.0	76.2
4"	130.0	116.5	105.0	101.6

### Contratuerca FIG.312

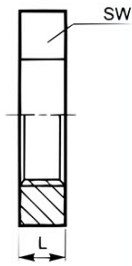

SIZE	L	SW		
1/4"	7.0	23.0		
3/8"	8.0	26.0		
1/2"	10.0	31.0		
3/4"	11.0	37.0		
1"	10.0	46.0		
1-1/4"	11.0	55.0		
1-1/2"	12.0	63.0		
2"	13.0	76.0		
2-1/2"	16.0	95.0		
3"	19.0	105.0		
4"	20.0	131.0		

### Manguito FIG.270

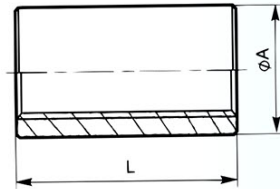

SIZE	ØA	L		
1/4"	18.5	25.0		
3/8"	21.3	26.0		
1/2"	26.4	34.0		
3/4"	31.8	36.0		
1"	39.5	43.0		
1-1/4"	48.3	48.0		
1-1/2"	54.5	48.0		
2"	69.0	56.0		
2-1/2"	87.0	65.0		
3"	103.0	71.0		
4"	129.5	83.0		



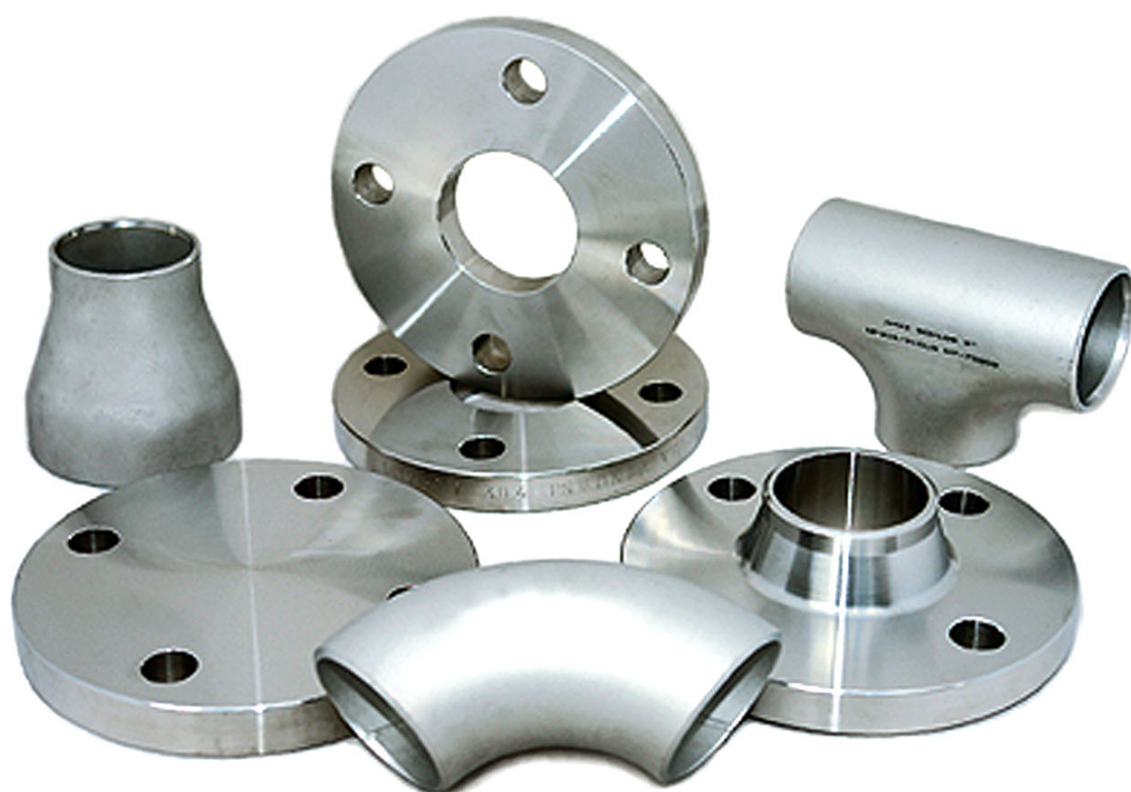

**Brida Plana Soldar PN6 DIN 2573/ EN 1092-1/UNI 2277**

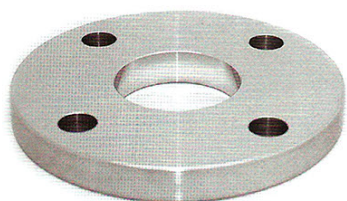
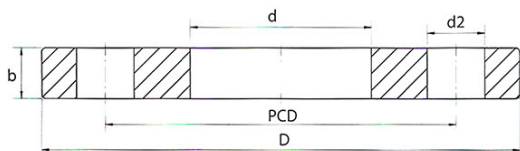

DN	d1 mm	d mm	D mm	b mm	PCD mm	NoHOLES	THREAD	d2 mm
15	20	21	80	10	55	4	M10	11
	21,3	22	80	10	55			
20	25	26	90	12	65	4	M10	11
	26,9	28	90	12	65			
25	30	31	100	12	75	4	M10	11
	33,7	34	100	12	75			
32	38	39	120	14	90	4	M12	14
	42,4	43	120	14	90			
40	44,5	45,5	130	14	100	4	M12	14
	48,3	49	130	14	100			
50	54	~54	140	14	110	4	M12	14
	57	58,1	140	14	110			
	60,3	62	140	14	110			
65	70	71	160	14	130	4	M12	14
	76,1	77	160	14	130			
80	84	~84	190	16	150	4	M16	18
	88,9	90	190	16	150			
100	104	~104	210	16	170	4	M16	18
	108	109,6	210	16	170			
125	114,3	116	210	16	170	8	M16	18
	129	~129	240	18	200			
	133	134,8	240	18	200			
	139,7	141	240	18	200			
150	154	~154	265	20	225	8	M16	18
	159	161,1	265	20	225			
	168,3	170	265	20	225			

**Brida Ciega PN6 DIN 2527/ UNI 6091-67**

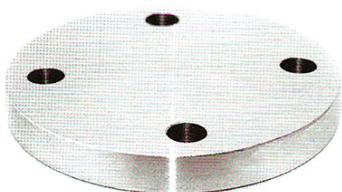
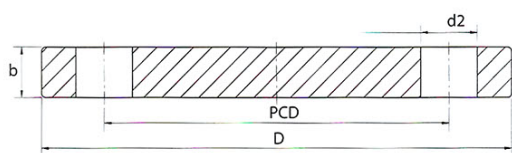

DN	d1 mm	D mm	b mm	PCD mm	NoHOLES	THREAD	d2 mm
15	20	80	10	55	4	M10	11
	21,3	80	10	55			
20	25	90	12	65	4	M10	11
	26,9	90	12	65			
25	30	100	12	75	4	M10	11
	33,7	100	12	75			
32	38	120	14	90	4	M12	14
	42,4	120	14	90			
40	44,5	130	14	100	4	M12	14
	48,3	130	14	100			
50	54	140	14	110	4	M12	14
	57	140	14	110			
	60,3	140	14	110			
65	70	160	14	130	4	M12	14
	76,1	160	14	130			
80	84	190	16	150	4	M16	18
	88,9	190	16	150			
100	104	210	16	170	4	M16	18
	108	210	16	170			
125	114,3	210	16	170	8	M16	18
	129	240	18	200			
	133	240	18	200			
	139,7	240	18	200			
150	154	265	20	225	8	M16	18
	159	265	20	225			
	168,3	265	20	225			

**Brida Plana Soldar PN10 DIN 2576/ EN 1092-1/UNI 2277**

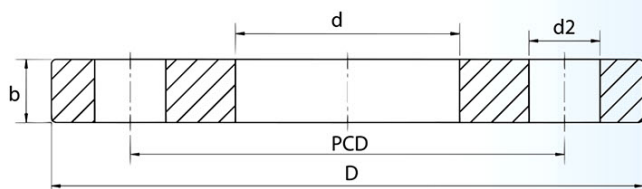

DN	d1 mm	d mm	D mm	b mm	PCD mm	NoHOLES	THREAD	d2 mm
15	20	21	95	12	65	4	M12	14
	21,3	22						
20	25	26	105	14	75	4	M12	14
	26,9	28						
25	30	31	115	14	85	4	M12	14
	33,7	34						
32	38	39	140	16	100	4	M16	18
	42,4	43						
40	44,5	45,5	150	16	110	4	M16	18
	48,3	49						
50	54	~54	165	18	125	4	M16	18
	57	58,1						
	60,3	62						
65	70	71	185	18	145	4	M16	18
	76,1	77						
80	84	~84	200	20	160	4	M16	18
	88,9	90						
100	104	~104	220	22	180	8	M16	18
	108	109,6						
	114,3	116						
125	129	~129	250	24	210	8	M16	18
	133	134,8						
	139,7	141						
150	154	~154	285	24	240	8	M20	22
	159	161,1						
	168,3	170						
200	204	~204	340	26	295	8	M20	22
	219,1	221						
250	254	~256	395	28	350	12	M20	22
	273	275						
300	304	~306	445	28	400	12	M20	22
	323,9	326						
350	355,6	358	505	30	460	16	M20	22
400	406,4	409	565	32	515	16	M22	25

**Brida Plana Soldar PN16 DIN 2577/EN 1092-1/UNI 2278**

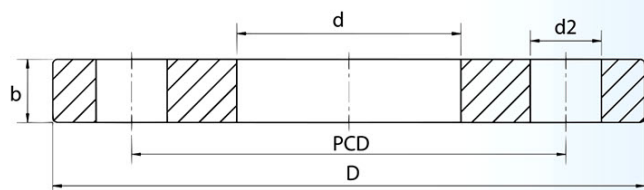

DN	d1 mm	d mm	D mm	b mm	PCD mm	NoHOLES	THREAD	d2 mm
15	20	21	95	12	65	4	M12	14
	21,3	22						
20	25	26	105	14	75	4	M12	14
	26,9	28						
25	30	31	115	14	85	4	M12	14
	33,7	34						
32	38	39	140	16	100	4	M16	18
	42,4	43						
40	44,5	45,5	150	16	110	4	M16	18
	48,3	49						
50	54	~54	165	18	125	4	M16	18
	57	58,1						
	60,3	62						
65	70	71	185	18	145	4	M16	18
	76,1	77						
80	84	~84	200	20	160	8	M16	18
	88,9	90						
100	104	~104	220	22	180	8	M16	18
	108	109,6						
	114,3	116						
125	129	~129	250	24	210	8	M16	18
	133	134,8						
	139,7	141						
150	154	~154	285	24	240	8	M20	22
	159	161,1						
	168,3	170						
200	204	~204	340	26	295	12	M20	22
	219,1	221						
250	254	~256	405	32	355	12	M22	25
	273	275						
300	304	~306	460	32	410	12	M22	25
	323,9	326						
350	355,6	358	520	36	470	16	M22	25
400	406,4	409	580	38	525	16	M27	30



### Brida Plana Soldar reducida PN10 EN 1092-1

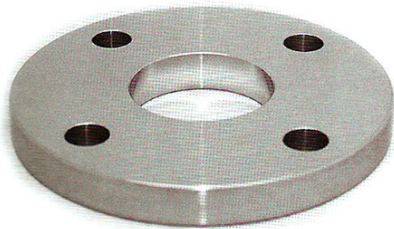
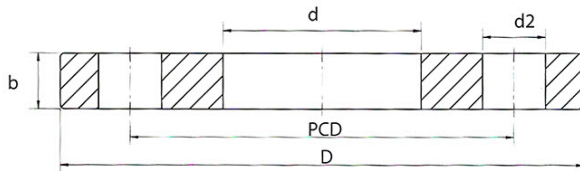

DN	d1	d	D	b	PCD	NoHOLES	THREAD	d2
mm	mm	mm	mm	mm	mm	mm	mm	mm
15	20	21	95	10	65	4	M12	14
	21,3	22						
20	25	26	105	10	75	4	M12	14
	26,9	28						
25	30	31	115	10	85	4	M12	14
	33,7	34						
32	38	39	140	10	100	4	M16	18
	42,4	43						
40	44,5	45,5	150	10	110	4	M16	18
	48,3	49						
50	54	~54	165	10	125	4	M16	18
	57	58,1						
65	60,3	62						
	70	71	185	12	145	4	M16	18
80	76,1	77						
	84	~84	200	12	160	4	M16	18
PN16	88,9	90				8	M16	
	88,9	90						
100	104	~104	220	12	180	8	M16	18
	114,3	116						
125	129	~129	250	14	210	8	M16	18
	139,7	141						
150	154	~154	285	14	240	8	M20	22
	168,3	170						
200	204	~204	340	16	295	8	M20	22
	219,1	221						
PN16	204	~204	340	16	295	12	M20	22
PN16	219,1	221						
250	254	~256	395	18	350	12	M20	22
	273	275						
300	304	~306	445	18	400	12	M20	22
	323,9	326						
350	355,6	358	505	18	460	16	M20	22
	406,4	409	565	18	515	16	M22	25

### Brida Ciega PN16 EN 1092-1 15 A

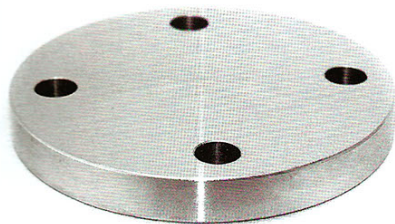
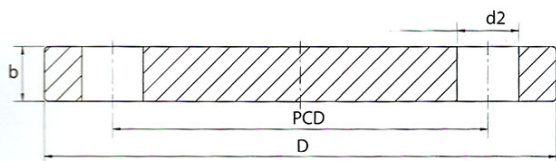

DN	d1	D	b	PCD	NoHOLES	THREAD	d2
mm	mm	mm	mm	mm	mm	mm	mm
15	20	95	16	65	4	M12	14
	21,3						
20	25	105	18	75	4	M12	14
	26,9						
25	30	115	18	85	4	M12	14
	33,7						
32	38	140	18	100	4	M16	18
	42,4						
40	44,5	150	18	110	4	M16	18
	48,3						
50	54	165	18	125	4	M16	18
	57						
65	60,3						
	70	185	18	145	4	M16	18
80	76,1						
	84	200	18	160	8	M16	18
100	88,9						
	104	220	18	180	8	M16	18
125	114,3						
	129	250	18	210	8	M16	18
150	139,7						
	154	285	22	240	8	M20	22
200	168,3						
	204	340	22	295	12	M20	22
250	219,1						
	254	405	26	355	12	M22	25
300	273						
	304	460	26	410	12	M22	25
350	323,9						
	355,6	520	26	470	16	M22	25
400	406,4	580	30	525	16	M27	30

**Brida Plana Soldar PN40 UNI 6084**

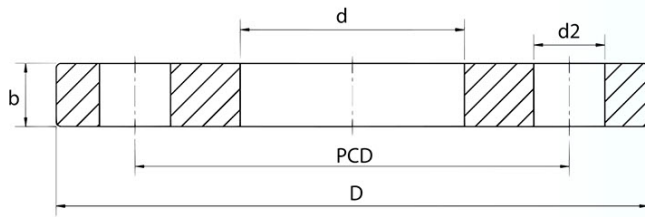

DN	d1	d	D	b	PCD	NoHOLES	THREAD	d2
mm	mm	mm	mm	mm	mm			mm
15	20	21	95	14	65	4	M12	14
	21,3	22						
20	25	26	105	16	75	4	M12	14
	26,9	28						
25	30	31	115	16	85	4	M12	14
	33,7	34						
32	38	39	140	18	100	4	M16	18
	42,4	43						
40	44,5	45,5	150	18	110	4	M16	18
	48,3	49						
50	54	~54	165	20	125	4	M16	18
	57	58,1						
	60,3	62						
65	70	71	185	24	145	8	M16	18
	76,1	77						
80	84	~84	200	26	160	8	M16	18
	88,9	90						
100	104	~104	235	26	190	8	M20	22
	108	109,6						
	114,3	116						
125	129	~129	270	28	220	8	M22	25
	133	134,8						
	139,7	141						
150	154	~154	300	30	250	8	M22	25
	159	161,1						
	168,3	170						
200	204	~204	375	36	320	12	M27	30
	219,1	221						
250	254	~256	450	44	385	12	M30	33
	273	275						
300	304	~306	515	48	450	16	M30	33
	323,9	326						
350	355,6	358	580	54	510	16	M33	36
400	406,4	409	660	60	585	16	M36x3	39

**Brida Cuello Soldar PN16 DIN2633/ UNI 2282**

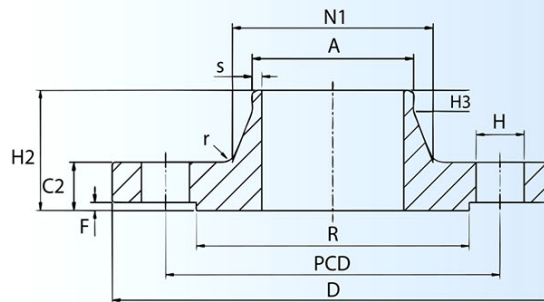

DN	A	D	PCD	N1	R	H2	C2	H3	F	r	s	H	N° HOLES	THREAD
mm	mm	mm	mm	mm	mm	mm	mm	mm	mm	mm	mm	mm	mm	mm
10	18	90	60	28	40	35	14	6	2	3	2,3	14	4	M12
15	22,5	95	65	32	45	35	14	6	2	3	2,5	14	4	M12
20	28	105	75	40	58	38	16	6	2	4	2,5	14	4	M12
25	34,5	115	85	45	68	38	16	6	2	4	2,8	14	4	M12
32	43,5	140	100	56	78	40	16	6	2	5	3	18	4	M16
40	49,5	150	110	64	88	42	16	7	3	5	3	18	4	M16
50	61,5	165	125	75	102	45	18	8	3	5	3,5	18	4	M16
65	77	185	145	90	122	45	18	10	3	6	3,5	18	4	M16
80	90	200	160	105	138	50	20	10	3	6	3,7	18	8	M16
100	115,5	220	180	131	158	52	20	12	3	6	3,7	18	8	M16
125	141	250	210	156	188	55	22	12	3	6	4	18	8	M16
150	170,5	285	240	184	212	55	22	12	3	8	5	22	8	M20
200	221	340	295	235	268	62	24	16	3	8	5	22	12	M20
250	275	405	355	292	320	70	26	16	3	10	5,5	25	12	M22
300	326	460	410	344	378	78	28	16	4	10	6	25	12	M22
350	357,5	520	470	390	438	82	30	16	4	12	6,4	25	16	M22
400	408,5	580	525	445	490	85	32	16	4	12	7	30	16	M27



**Brida Cuello Soldar PN40 DIN2635/ UNI2284**

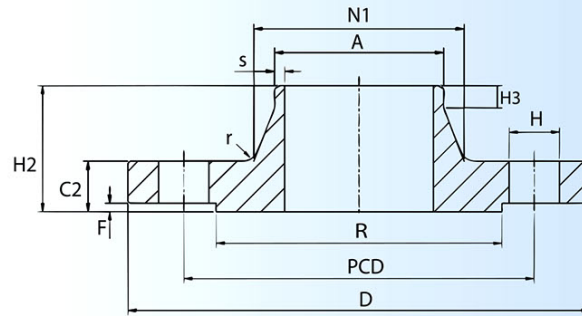

DN	A	D	PCD	N1	R	H2	C2	H3	F	r	s	H	N° HOLES	TEMPLATE THREAD
mm	mm	mm	mm	mm	mm	mm	mm	mm	mm	mm	mm	mm	mm	mm
10	18	90	60	28	40	35	16	6	2	3	2,3	14	4	M12
15	22,5	95	65	32	45	38	16	6	2	3	2,5	14	4	M12
20	28	105	75	40	58	40	18	6	2	4	2,5	14	4	M12
25	34,5	115	85	46	68	40	18	6	2	4	2,8	14	4	M12
32	43,5	140	100	56	78	42	18	6	2	5	3	18	4	M16
40	49,5	150	110	64	88	45	18	7	3	5	3	18	4	M16
50	61,5	165	125	75	102	48	20	8	3	5	3,5	18	4	M16
65	77	185	145	90	122	52	22	10	3	6	3,5	18	8	M16
80	90	200	160	105	138	58	24	12	3	6	3,7	18	8	M16
100	115,5	235	190	131	162	65	24	12	3	6	3,7	22	8	M20
125	141	270	220	156	188	68	26	12	3	6	4	25	8	M22
150	170,5	300	250	184	218	75	28	12	3	8	5	25	8	M22
200	221	375	320	235	285	88	34	16	3	8	5,5	30	12	M27
250	275	450	385	292	345	105	38	18	3	10	6,5	33	12	M30
300	326	515	450	344	410	115	42	18	4	10	7,3	33	12	M30
350	357,5	580	510	408	465	125	46	20	4	12	8	36	16	M33
400	408,5	660	585	462	535	135	50	20	4	12	9	39	16	M36X3

**Brida Plana PN40 DIN2527/ UNI 6095**

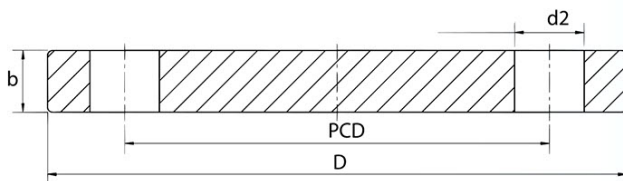

DN	D	PCD	b	d2	N° HOLES	Template
mm	mm	mm	mm	mm	mm	mm
10	90	60	16	14	4	M12
15	95	65	16	14	4	M12
20	105	75	18	14	4	M12
25	115	85	18	14	4	M12
32	140	100	18	18	4	M16
40	150	110	18	18	4	M16
50	165	125	20	18	4	M16
65	185	145	22	18	8	M16
80	200	160	24	18	8	M16
100	235	190	24	22	8	M20
125	270	220	26	25	8	M22
150	300	250	28	25	8	M22
200	375	320	34	30	12	M27
250	450	385	38	33	12	M30
300	515	450	42	33	16	M30
350	580	510	46	36	16	M33
400	660	585	50	39	16	M36X3



Codo 90° Largo Soldar Schedule

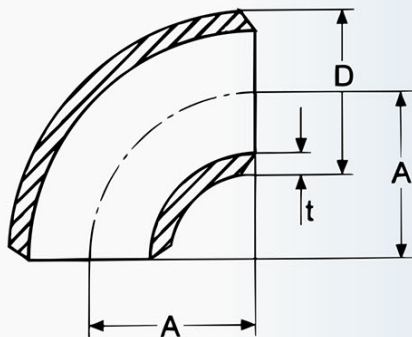

Dimensions in mm

Diameter	Schedule	D	t	A	kg/piece
1/2"	10s	21.3	2.11	38.1	0.060
	40s	21.3	2.77	38.1	0.080
	80s	21.3	3.73	38.1	0.100
3/4"	10s	26.7	2.11	38.1	0.070
	40s	26.7	2.87	38.1	0.090
	80s	26.7	3.91	38.1	0.110
1 "	10s	33.4	2.77	38.1	0.140
	40s	33.4	3.38	38.1	0.160
	80s	33.4	4.55	38.1	0.220
1 1/4 "	10s	42.2	2.77	47.6	0.230
	40s	42.2	3.56	47.6	0.250
	80s	42.2	4.85	47.6	0.400
1 1/2 "	10s	48.3	2.77	57.2	0.310
	40s	48.3	3.68	57.2	0.400
	80s	48.3	5.08	57.2	0.510
2 "	10s	60.3	2.77	76.2	0.510
	40s	60.3	3.91	76.2	0.710
	80s	60.3	5.54	76.2	0.910
2 1/2 "	10s	73.0	3.05	95.3	0.850
	40s	73.0	5.16	95.3	1.360
	80s	73.0	7.01	95.3	1.810
3 "	10s	88.9	3.05	114.3	1.220
	40s	88.9	5.49	114.3	2.180
	80s	88.9	7.62	114.3	2.980
3 1/2 "	10s	101.6	3.05	133.4	1.700
	40s	101.6	5.74	133.4	1.830
	80s	101.6	6.02	152.4	4.170
4 "	10s	114.3	3.05	152.4	2.150
	40s	114.3	6.02	152.4	4.170
	80s	114.3	8.56	152.4	6.180
5 "	10s	141.3	3.40	190.5	3.630
	40s	141.3	6.55	190.5	6.860
	80s	141.3	9.53	190.5	9.580
6 "	10s	168.3	3.40	228.6	4.900
	40s	168.3	7.11	228.6	10.890
	80s	168.3	10.97	228.6	16.330
8 "	10s	219.1	3.76	304.8	10.660
	40s	219.1	8.18	304.8	21.550
	80s	219.1	12.70	304.8	33.110
10 "	10s	273.1	4.19	381.0	19.500
	40s	273.1	9.27	381.0	38.560
	80s	273.1	12.70	381.0	59.420
12 "	10s	323.9	4.57	457.2	27.220
	40s	323.9	9.53	457.2	59.420
	80s	323.9	12.70	457.2	89.270
14 "	10s	355.6	4.78	533.4	36.300
16 "	10s	406.4	4.78	609.6	47.630
18 "	10s	457.2	4.78	685.8	59.870
20 "	10s	508.0	5.54	762.0	99.790
24 "	10s	609.6	6.35	914.4	140.610















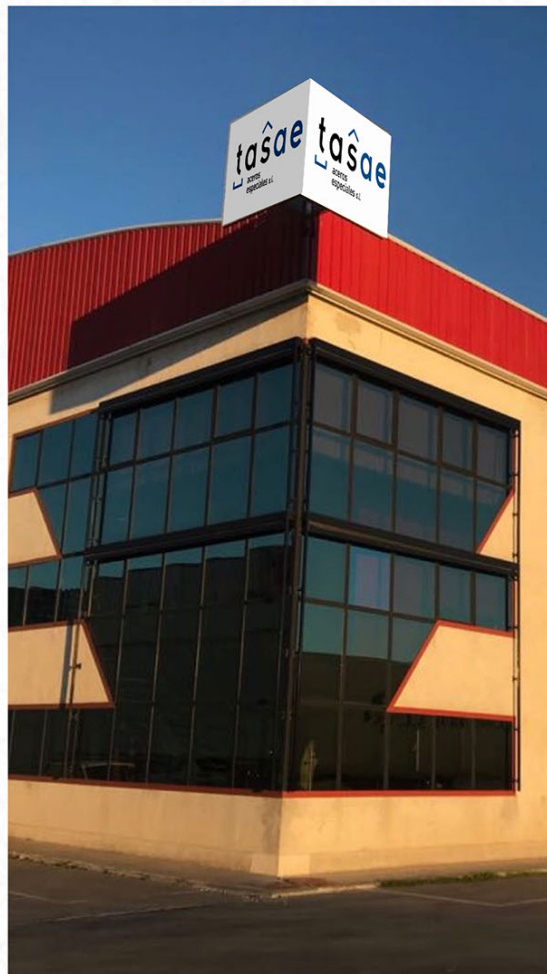

**Pol. Ind. Las Quemadas**  
**c/José de Gálvez y Aranda, 31-32 14014 CÓRDOBA**  
**Tel : +34 957 41 84 78**  
**info@tasae.es**  
**www.tasae.es**